

技术参数 (Specifications)

适用线规 (Applicable wires) : AWG#24~AWG#20
 温度范围 (Temperature range) : -25°C~85°C
 额定电压 (Voltage rating) : 250V AC/DC
 额定电流 (Current rating) : 5A
 接触电阻 (Contact resistance) : ≤20mΩ
 绝缘电阻 (Insulation resistance) : ≥1000MΩ
 耐压 (Withstand voltage) : 2200V AC/minute
 灼热丝测试 (Glow-wire test) : 850°C ;750°C no flame

材料(Material):

Housing:PC/PET UL94V-0
 Wafer:PC/PET UL94V-0;Brass Tin-plated

插簧 Contact

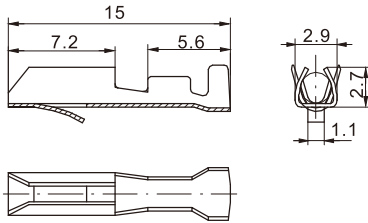

型号 Type	适用导线范围 Wire Range		导线外径 Wire ins.Dis
	mm ²	AWG#	
CH-TJC41	0.22-0.5	24 ~ 20	1.4~1.8
材质·表面处理 Material and Finish			
磷青铜 Phos·bronze Tin·Plated			

线数 Poles	孔座 Housing	阳连接器 (立式, 直插, 含定位柱) Header (V, DIP, W/Boss)
1	TJC46-1Y 	TJC46-1AD
2	TJC46-2Y 	TJC46-2AD

TJC46 型条形连接器

TJC46 Bar Connector

间距 (space) : 7.8-5mm

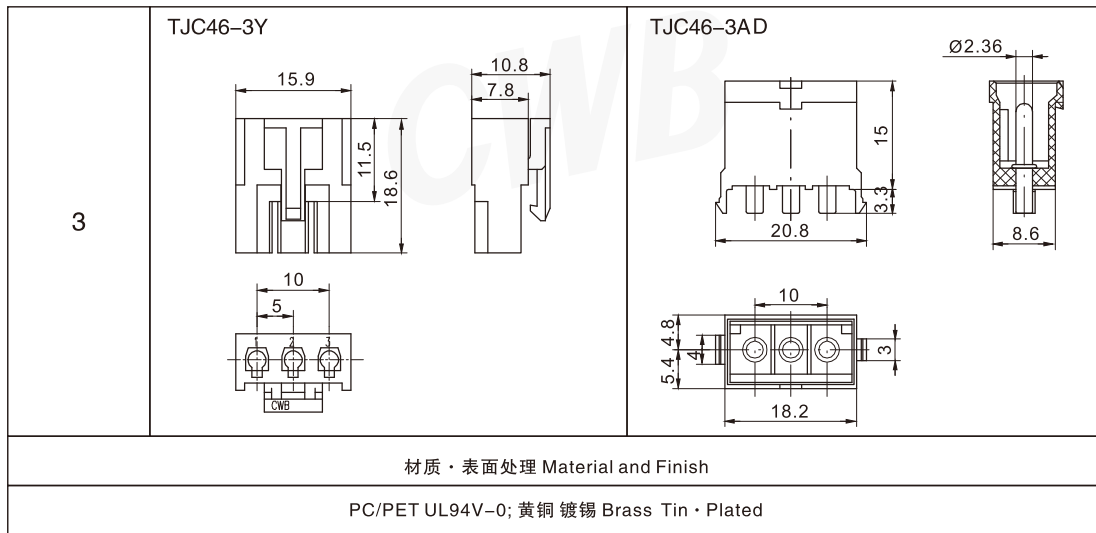

安装尺寸 Mounting Measurement

TJC46-1AD

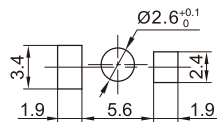

PCB Layout

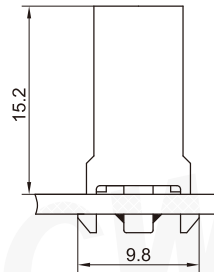

Assembly View (DIM FYI)

TJC46-2AD

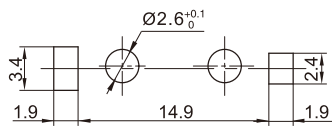

PCB Layout

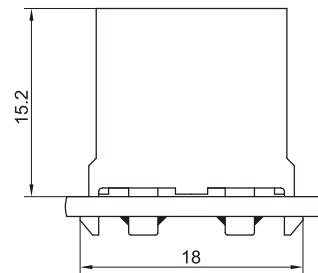

Assembly View (DIM FYI)

TJC46-3AD

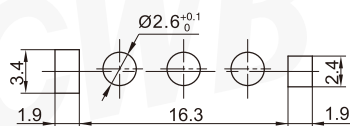

PCB Layout

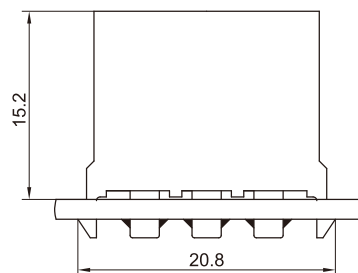

Assembly View (DIM FYI)